

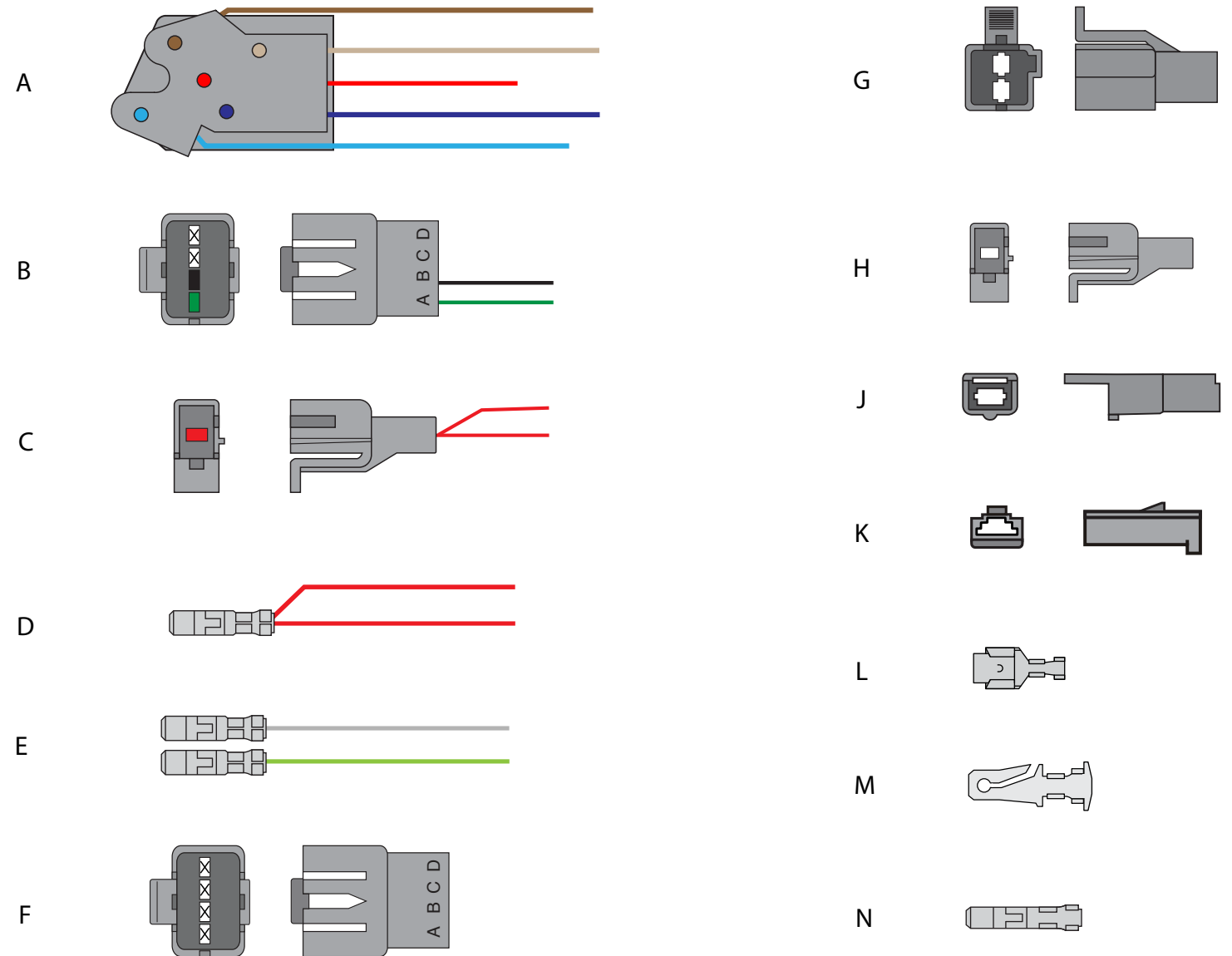

# American Autowire

1. This kit is designed to work with our 510683 and 510689 Firebird Classic Update Kits. It is **NOT** intended to be used by itself or with any other aftermarket electrical system.

2. This kit requires that you use the factory door harnesses. American Autowire does offer factory door harnesses for most applications, most require that you send in your original door boot for reuse.

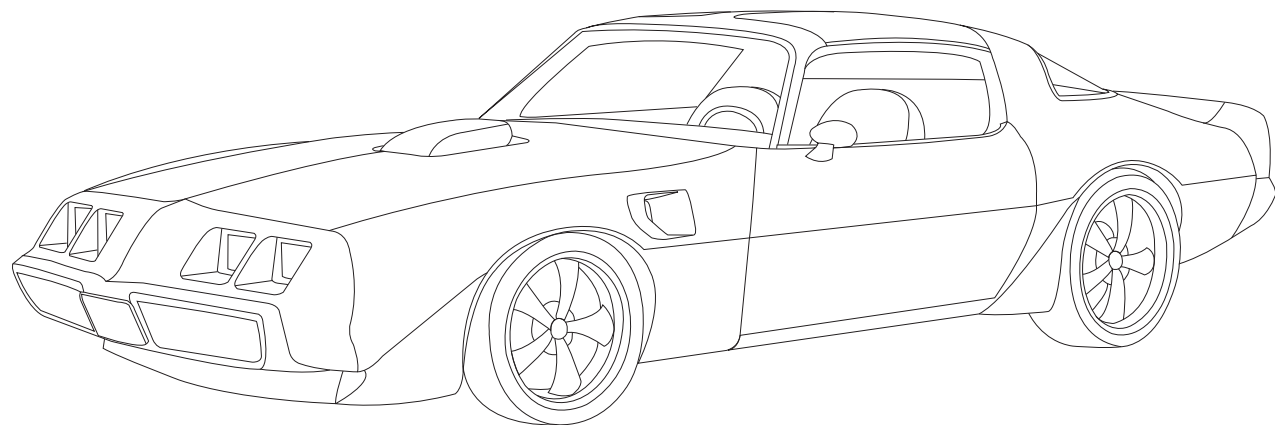

## **1977-80 Firebird** *Classic Update Series* *Power Window and Lock Kit*

### **510704**

© COPYRIGHT 2004 American Autowire / Factory-Fit  
Used with express permission of  
American Autowire / Factory-Fit

www.americanautowire.com 856-933-0801

Power Window and  
Lock Kit  
1977-80 Firebird  
Classic Update Series  
**510704**  
**92971845**

Rev 0.0 5/30/2017 KW

# Power lock harness installation instructions:

1977

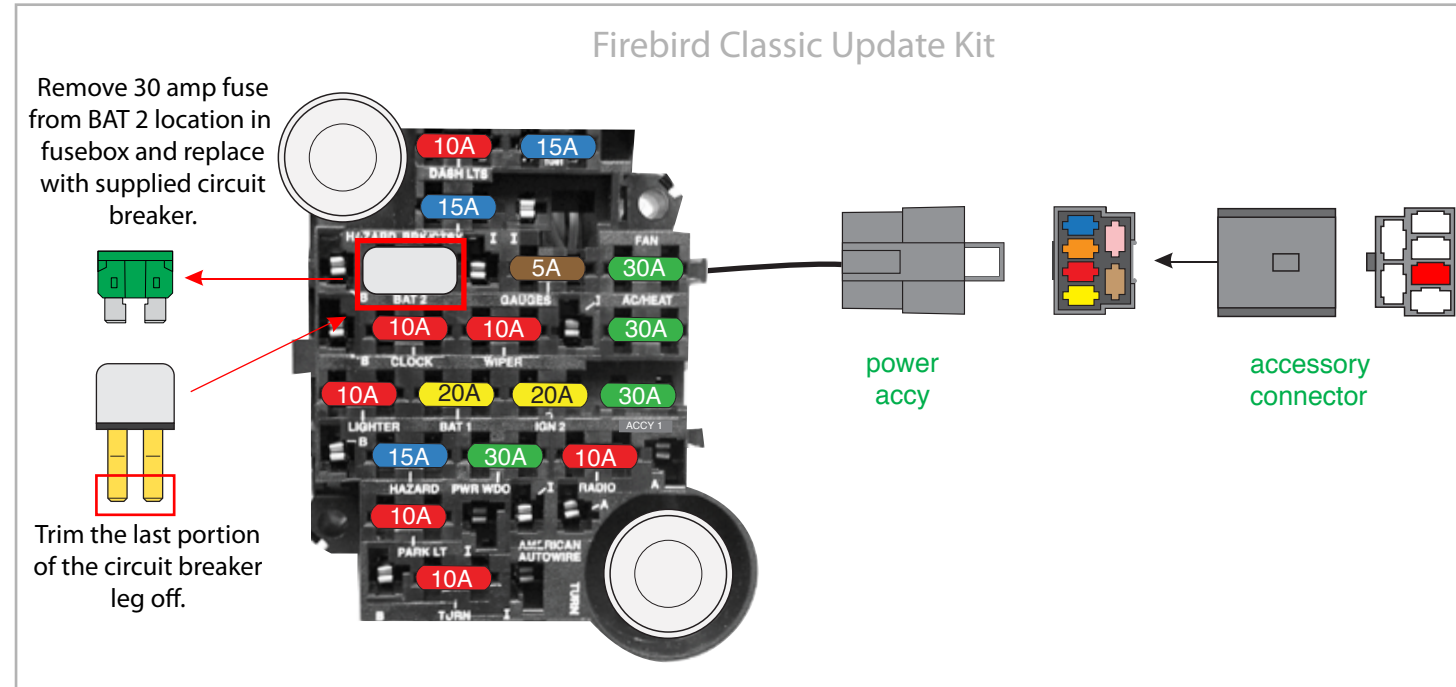

Use the accessory connector supplied with your Classic Update Kit. Plug into cavity indicated in red for battery power.

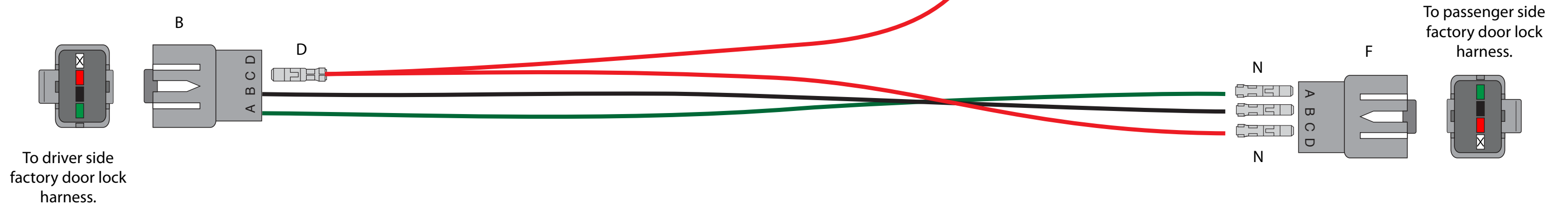

# Power window harness installation instructions:

92971865

1977-80

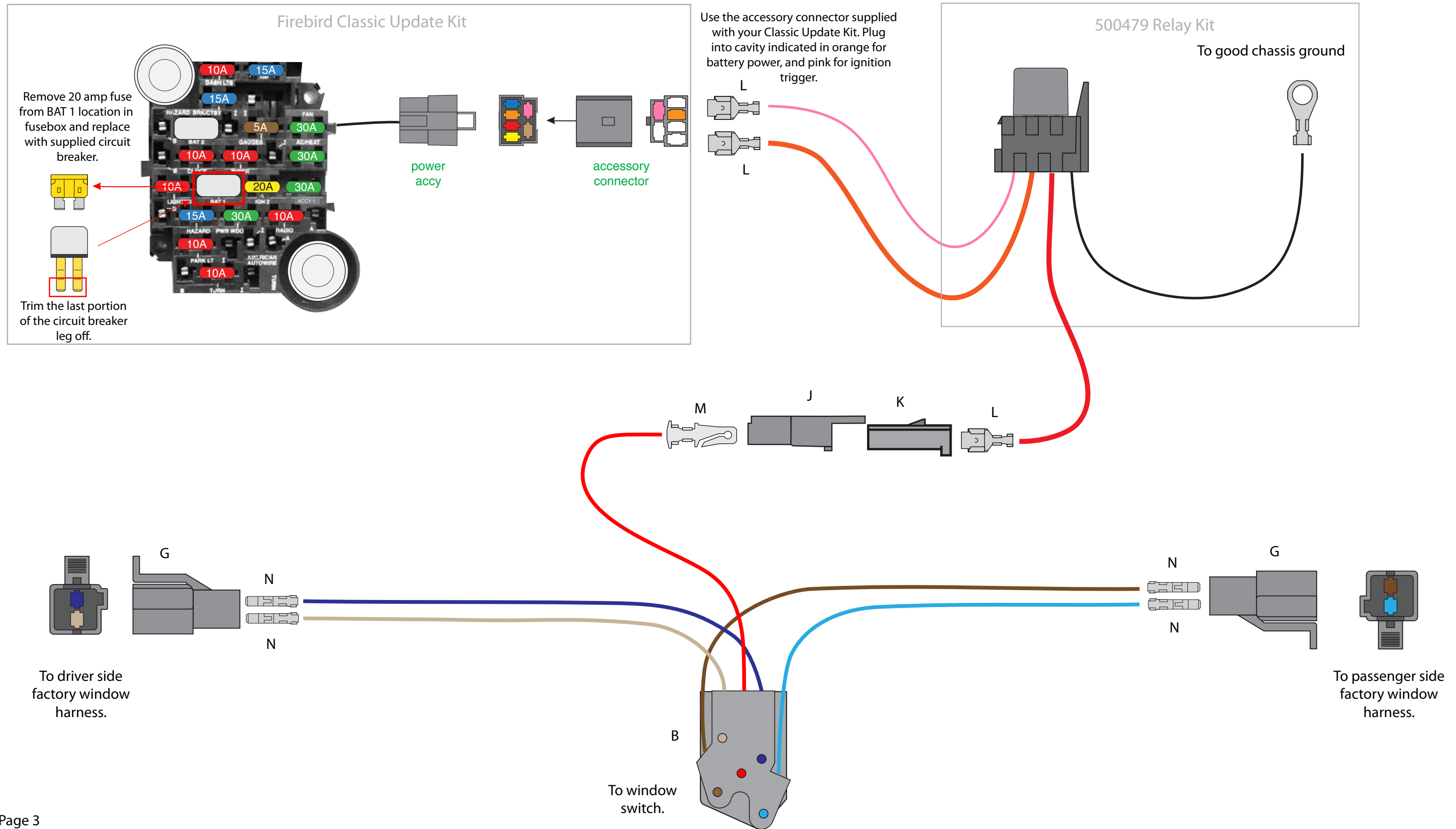

# Power lock harness installation instructions:

92971865

## 1978-80

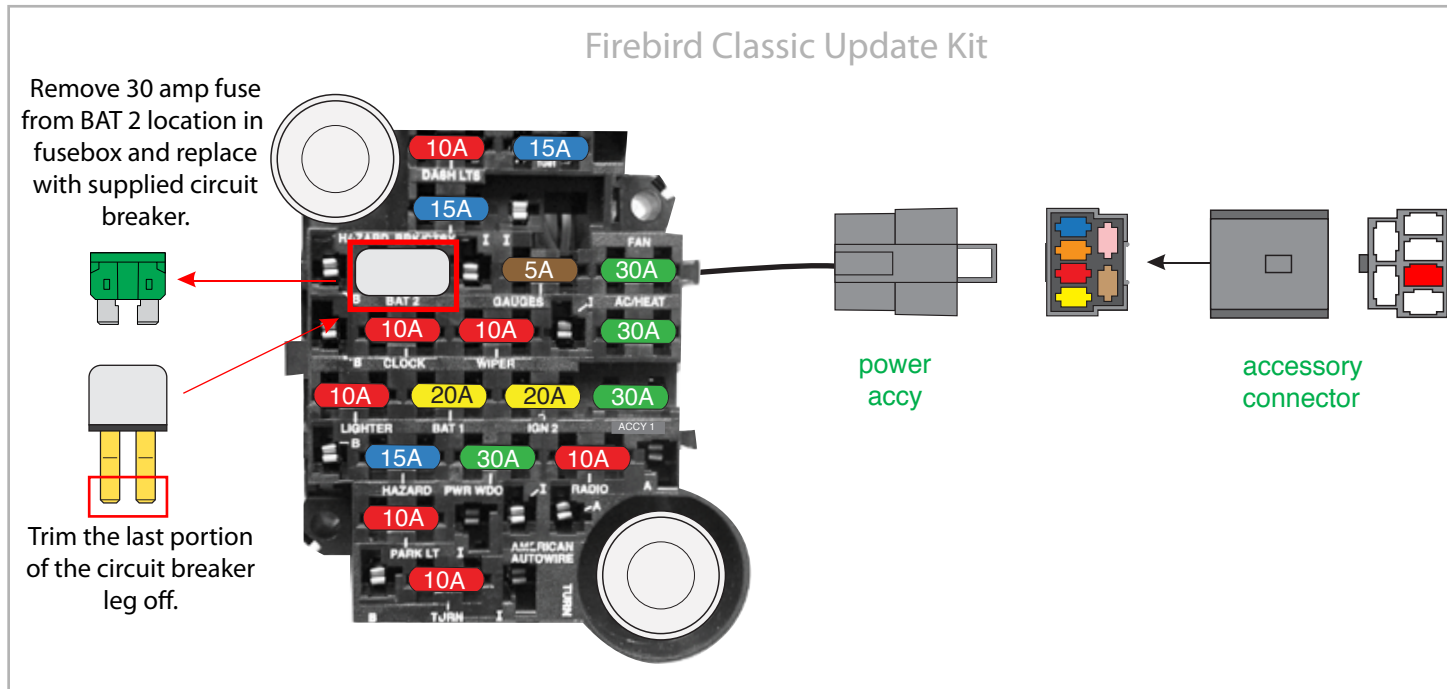

Use the accessory connector supplied with your Classic Update Kit. Plug into cavity indicated in red for battery power.

L

